

Compiled by
SHREE CONSTRUCTIONS AND INTERIORS



As a state-of-the-art player in the Indian construction & interior industry, we have always entrusted Vastu Shastra to create spaces with positive vibrations, peace and prosperity.

- Vastu Shastra is not just about religion but a practical guide to ensure a home breathes.
- From the foundation to the final touch-ups, a holistic and modern approach to architecture with mindful adherence to Vastu principles is essential.
- This report will guide you on building harmony in spaces, from kitchens to commercial superstructures.
- A thoughtful analysis of Delhi's climate is included to ensure your project is comfortable, energy-efficient, and respectful of traditional Indian construction wisdom.



Homes Where a sense of belonging resides...



Shagun:

Commence construction during auspicious months like Vaishakh and Chaitra. Mondays, Wednesdays, Thursdays and Fridays are ideal to begin the project as the planets tend to be at the right place to give you prosperity.

Significant Customs:

Ensure every room receives natural light.

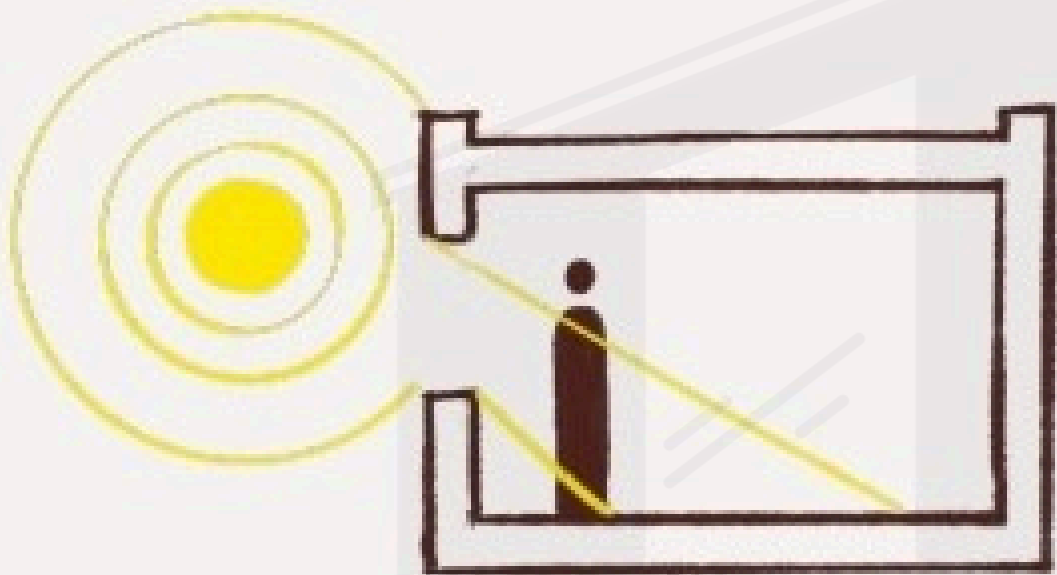

Bhoomi Pujan is a must for every home.

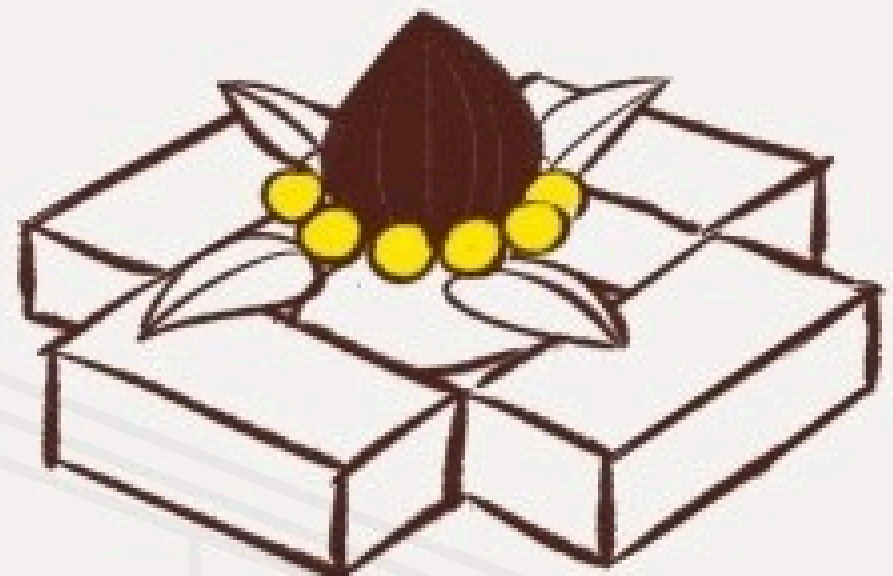

Avoid reusing materials from demolished structures as they bring in negative energy.

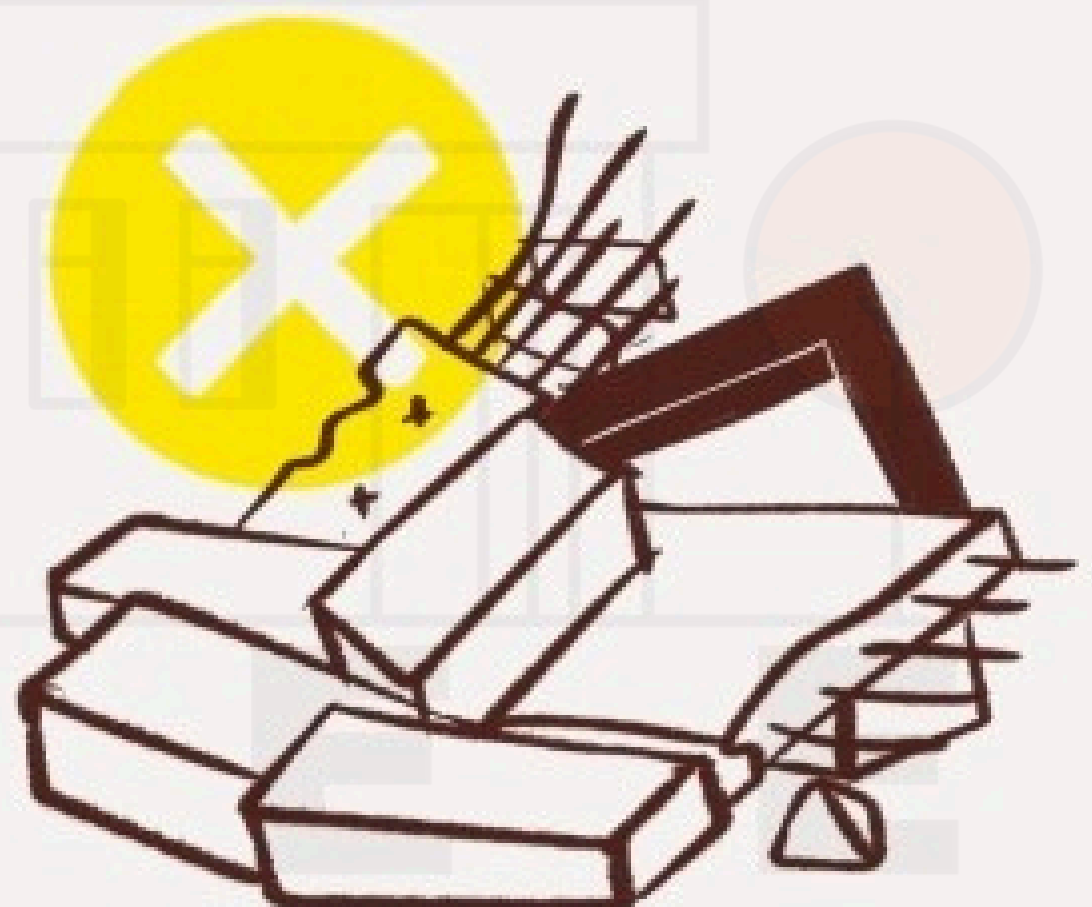

Directional Considerations:

North and east are the most auspicious directions for the main door



The master bedroom should be in the southwest direction

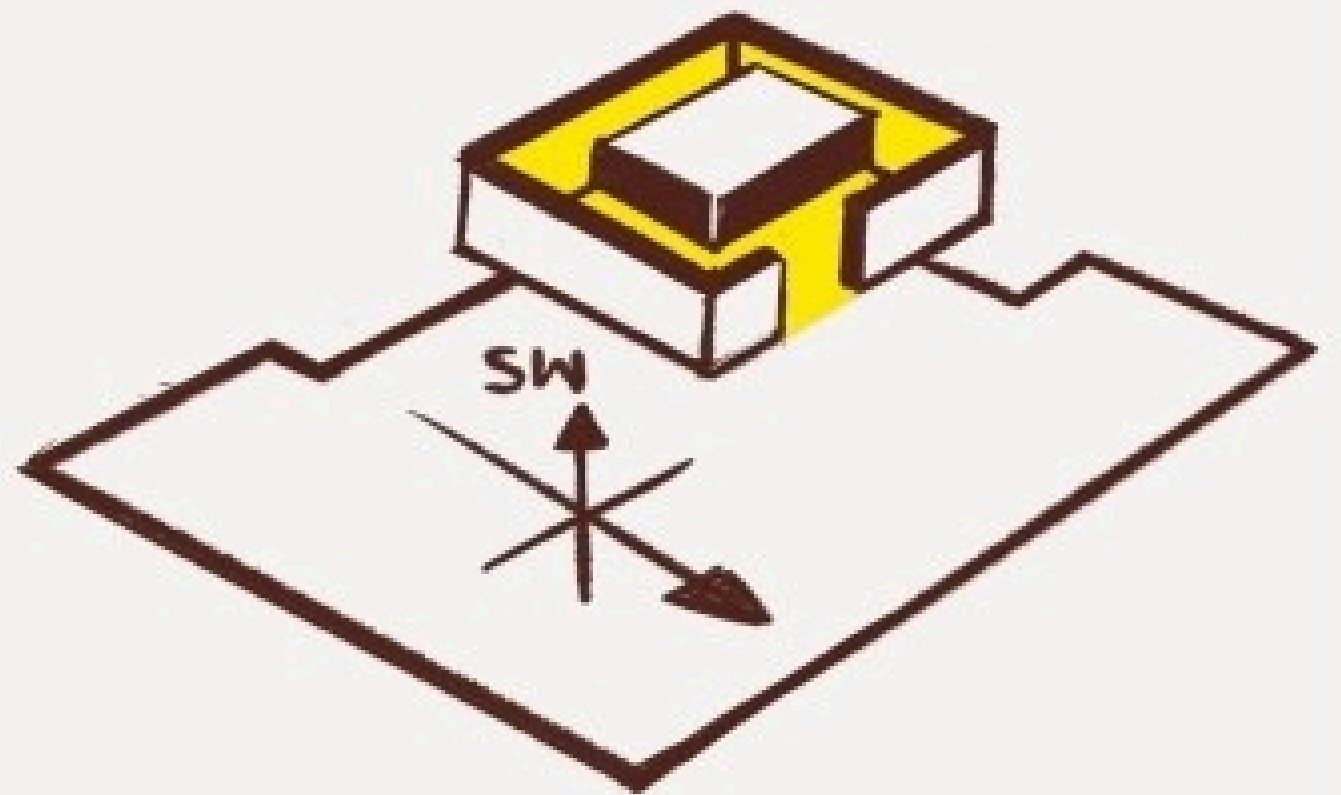

Water sources like wells, bore-wells or tanks should be located in the north-east.



Form Composition:

The shape of the plot should ideally be square or rectangular.

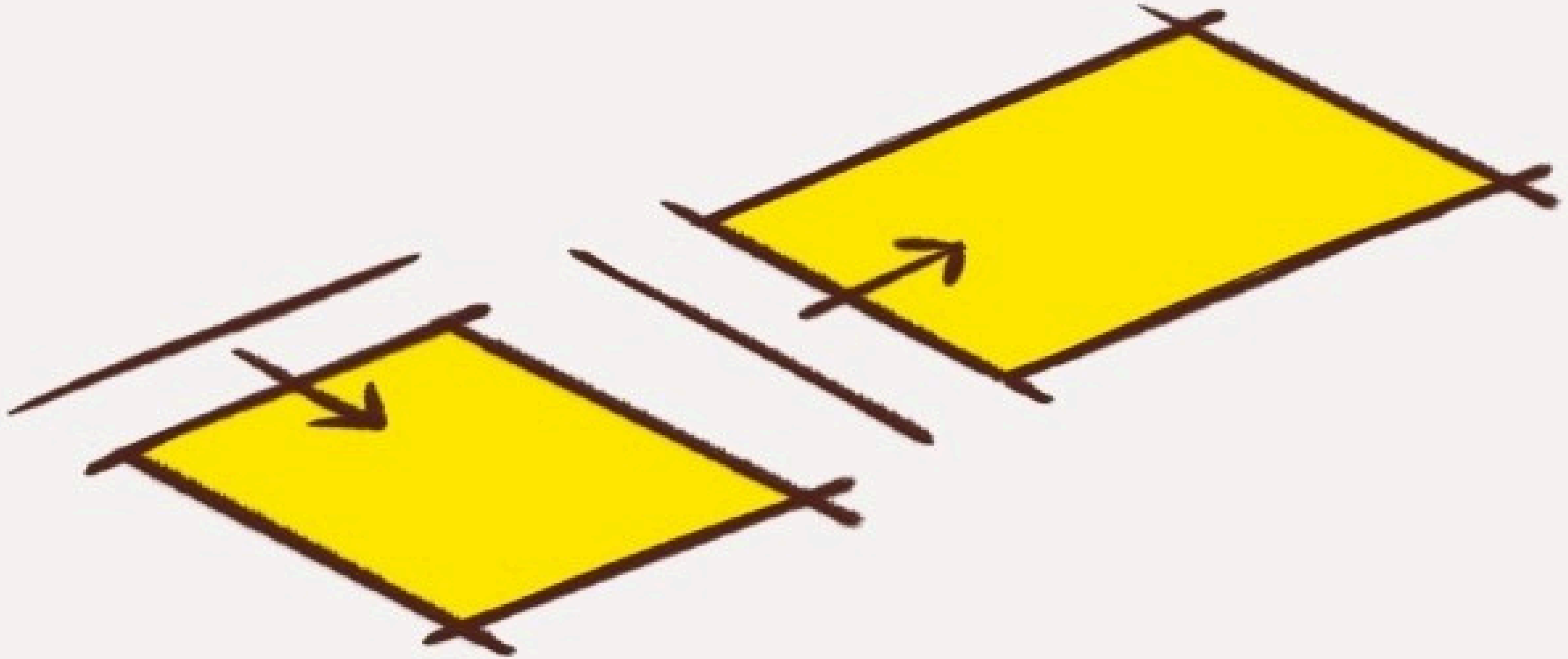

Avoid T-shaped or irregular plots as they are believed to cause misfortune or financial troubles.

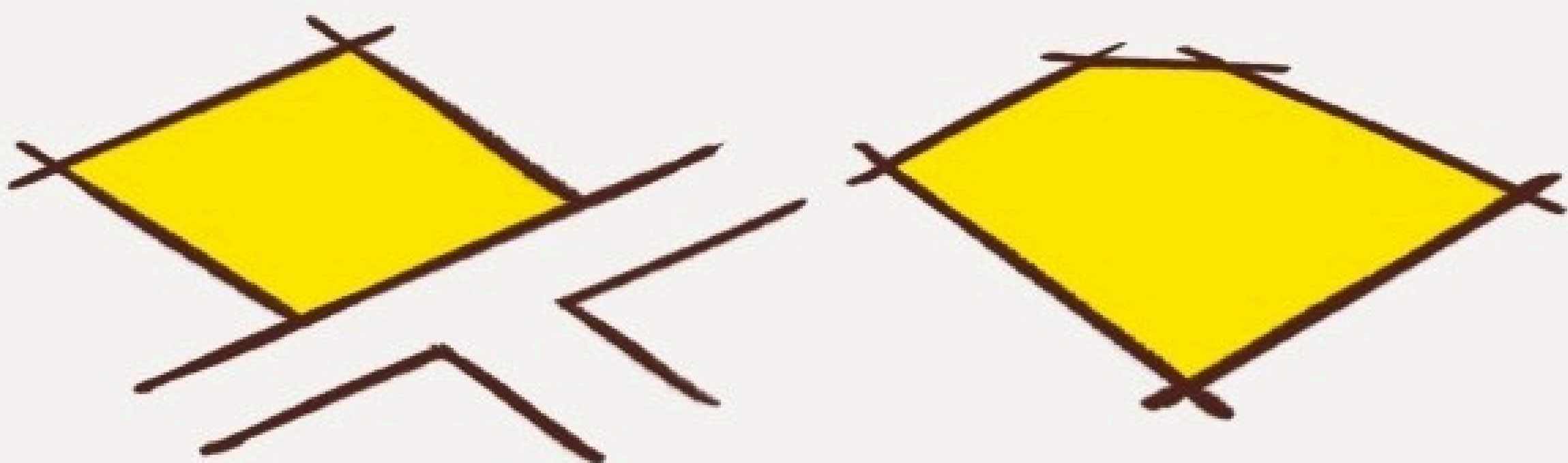



Home Interiors Where your eyes and heart are in sync...



Shagun:

Similar to home construction, begin your interior revamps in auspicious months like Magha and Margashirsha. Avoid beginning a project during the chaturmas and the months of Shravana or Ashadha.

Significant Customs:

Use natural materials like wood, stone and metals to invite positive energy into the space.



Avoid clutter in living spaces, especially the main entrance.

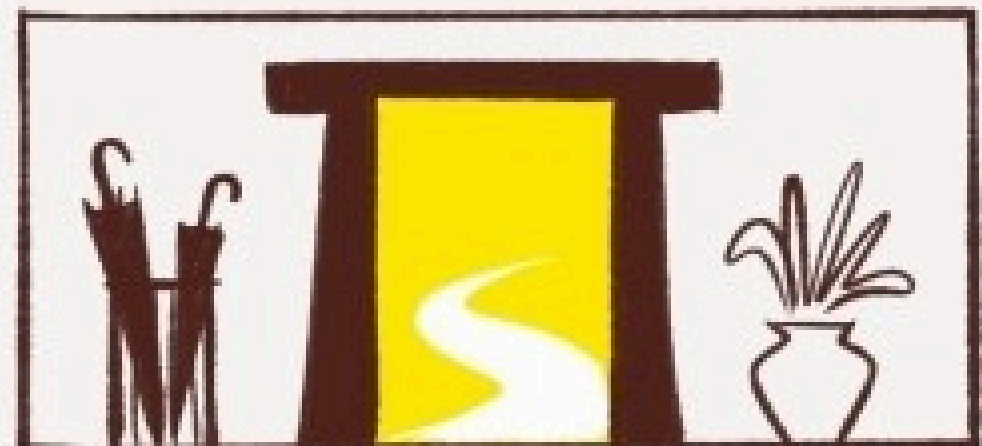

Avoid mirrors in bedrooms facing the bed.



Directional Considerations:

North and east are the most auspicious directions for the main door.



Storage units should be in the Southwest or West side of the rooms.



Living rooms should ideally be in the northeast corner of the house.

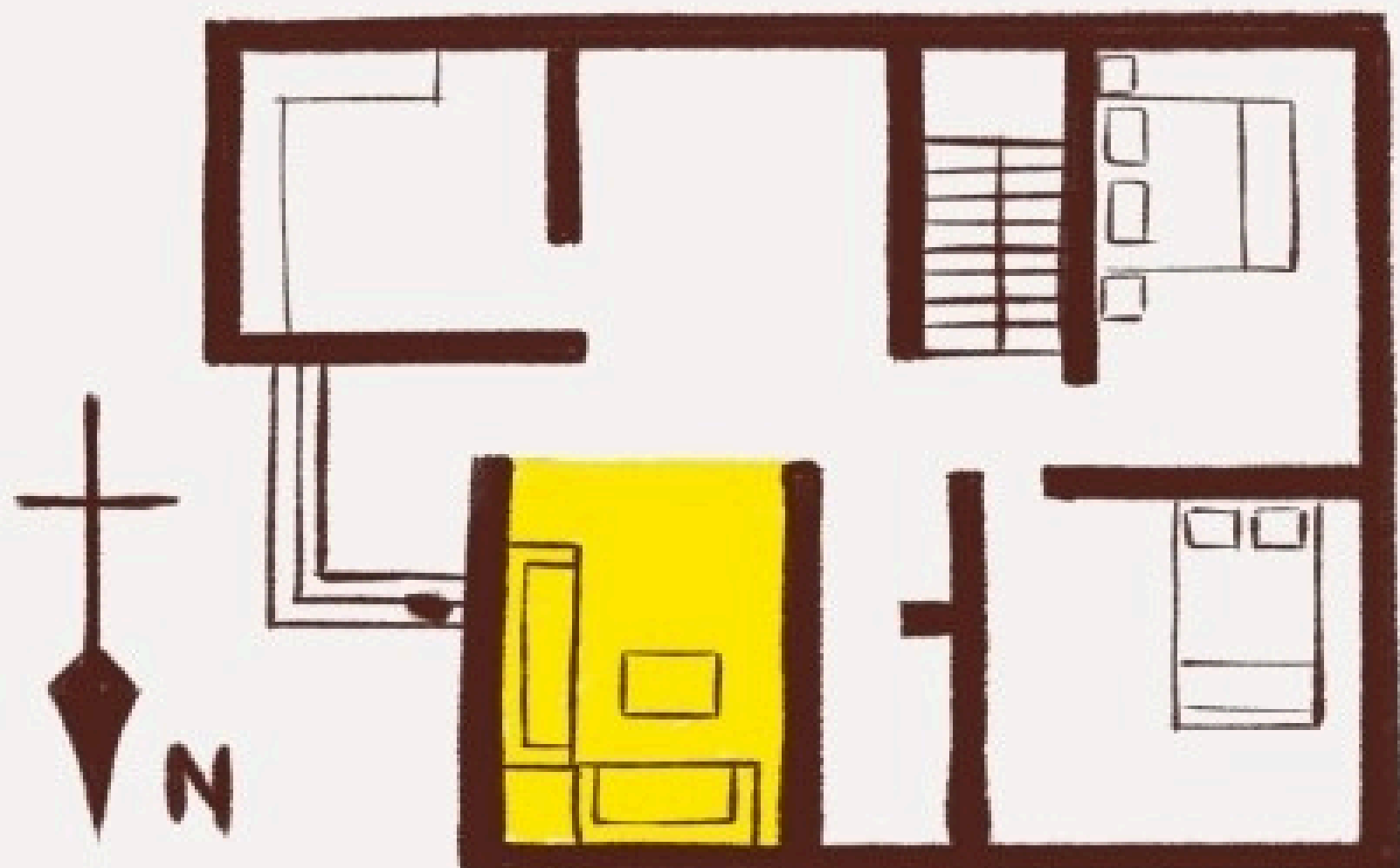

Form Composition:

Use rounded edges for furniture to soften energy flow and avoid sharp corners.

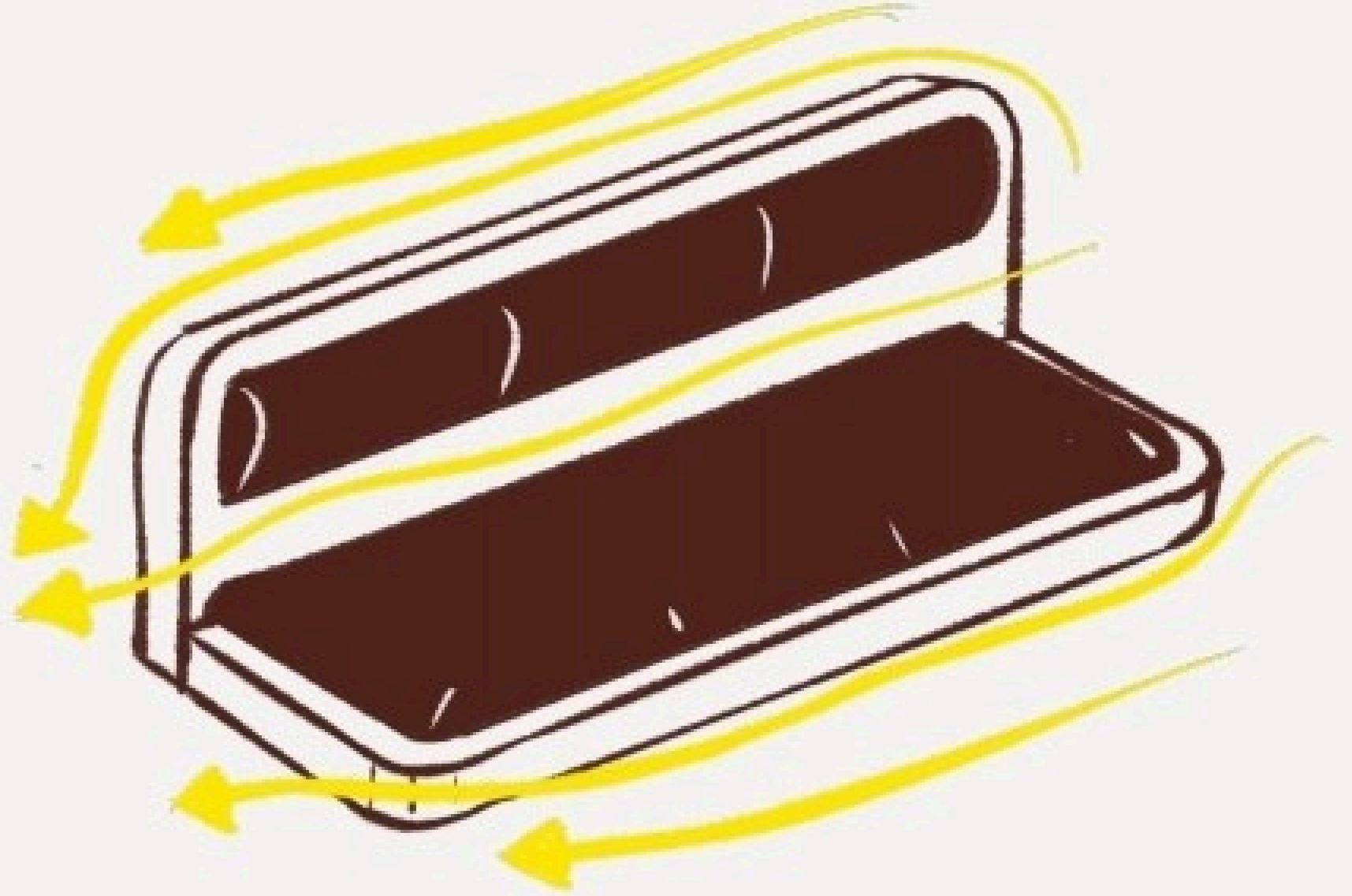

Rooms should be square or rectangular; odd shapes lead to confusion and unintentional anxiety within living spaces.

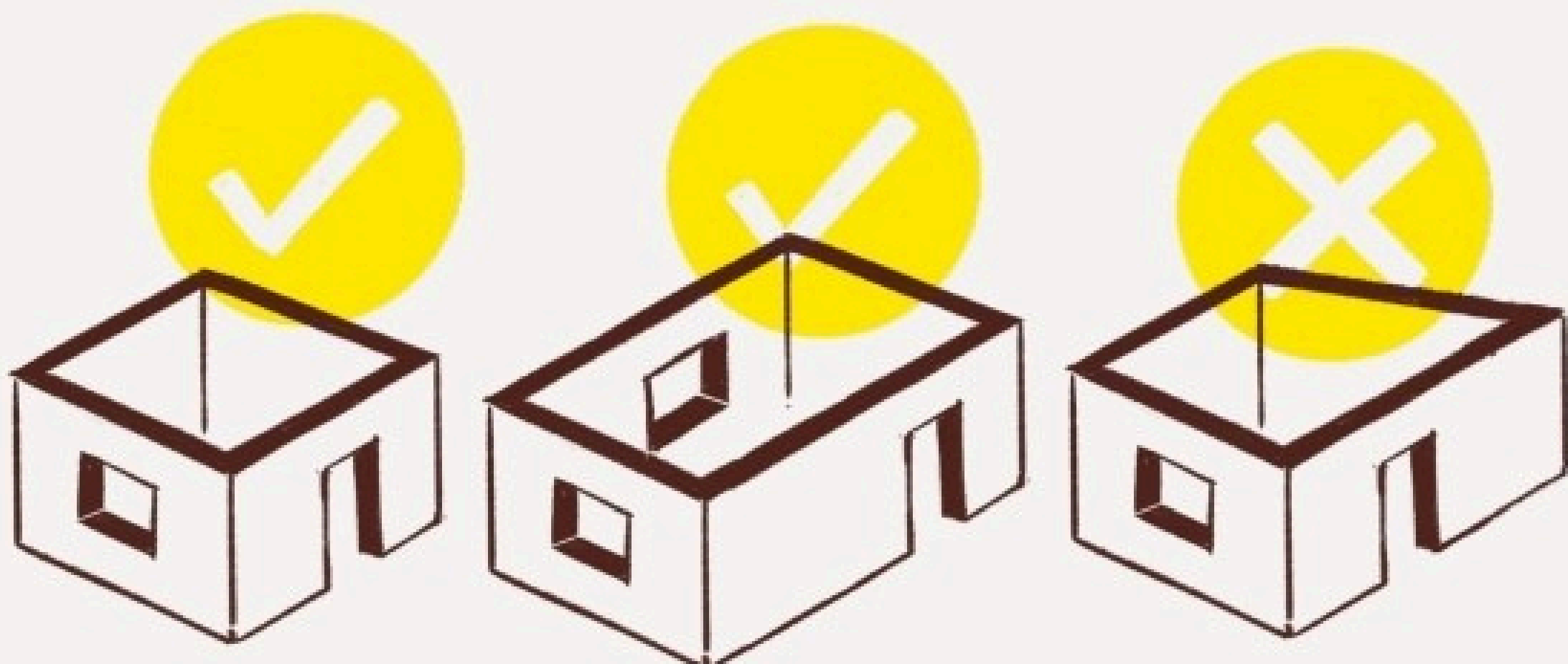

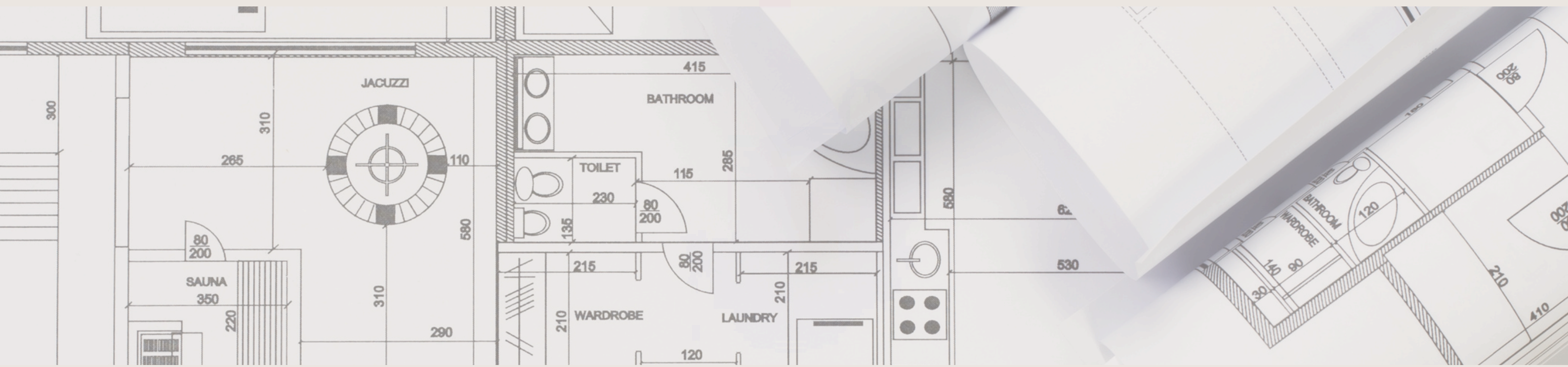

Kitchen Spaces

Where harmony is served...



Shagun:

Auspicious periods like Akshaya Tritiya are extremely ideal to begin kitchen remodeling and construction. Lunar phases like Amavasya (New Moon Day), Ekadashi (11th day of the lunar cycle) and chaturmas are considered inauspicious to begin working on your kitchen.

Significant Customs:

Never place the kitchen directly in front of the main entrance.



Avoid storing unused and broken utensils.

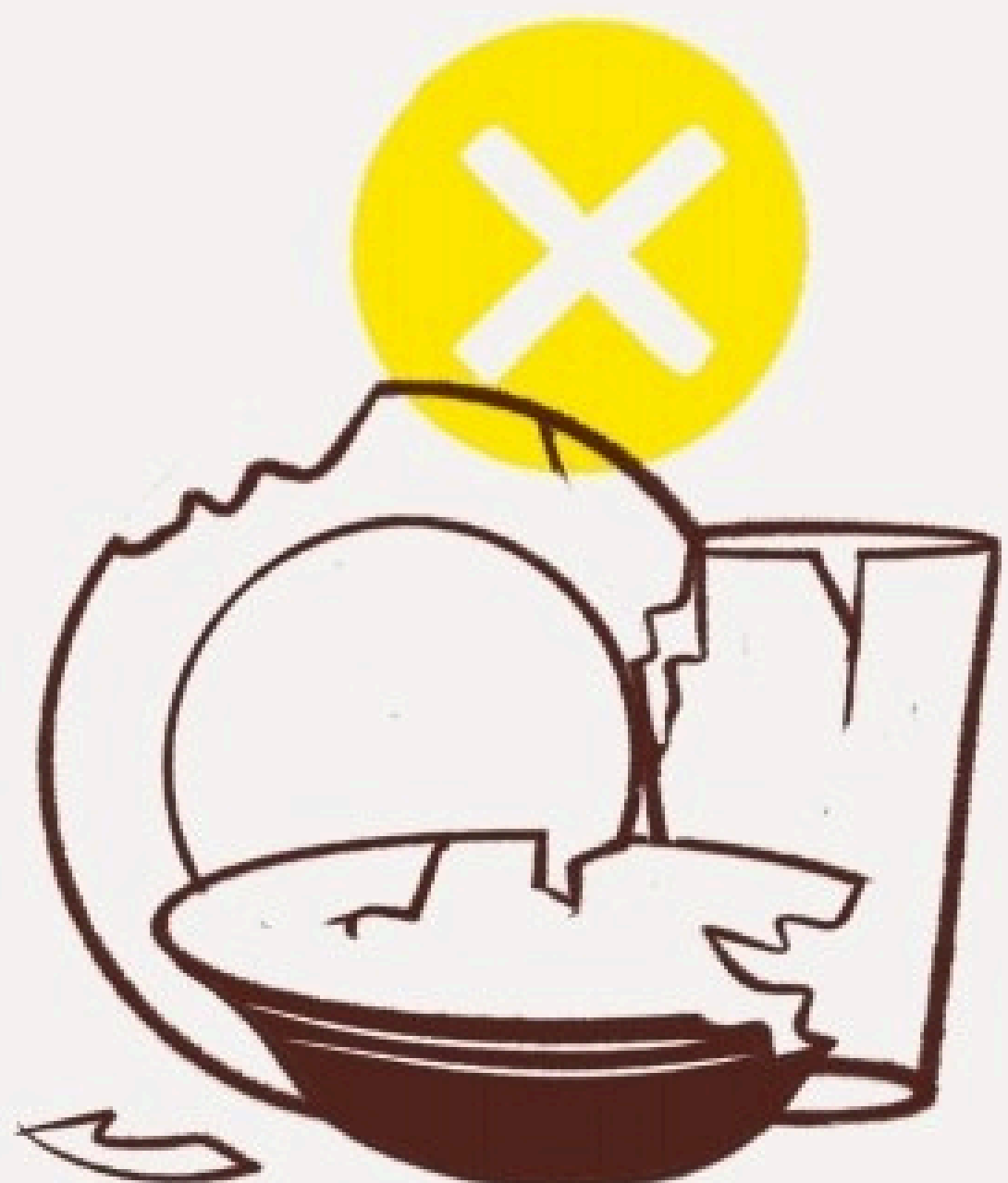

Directional Considerations:

The cook should ideally face east while cooking.

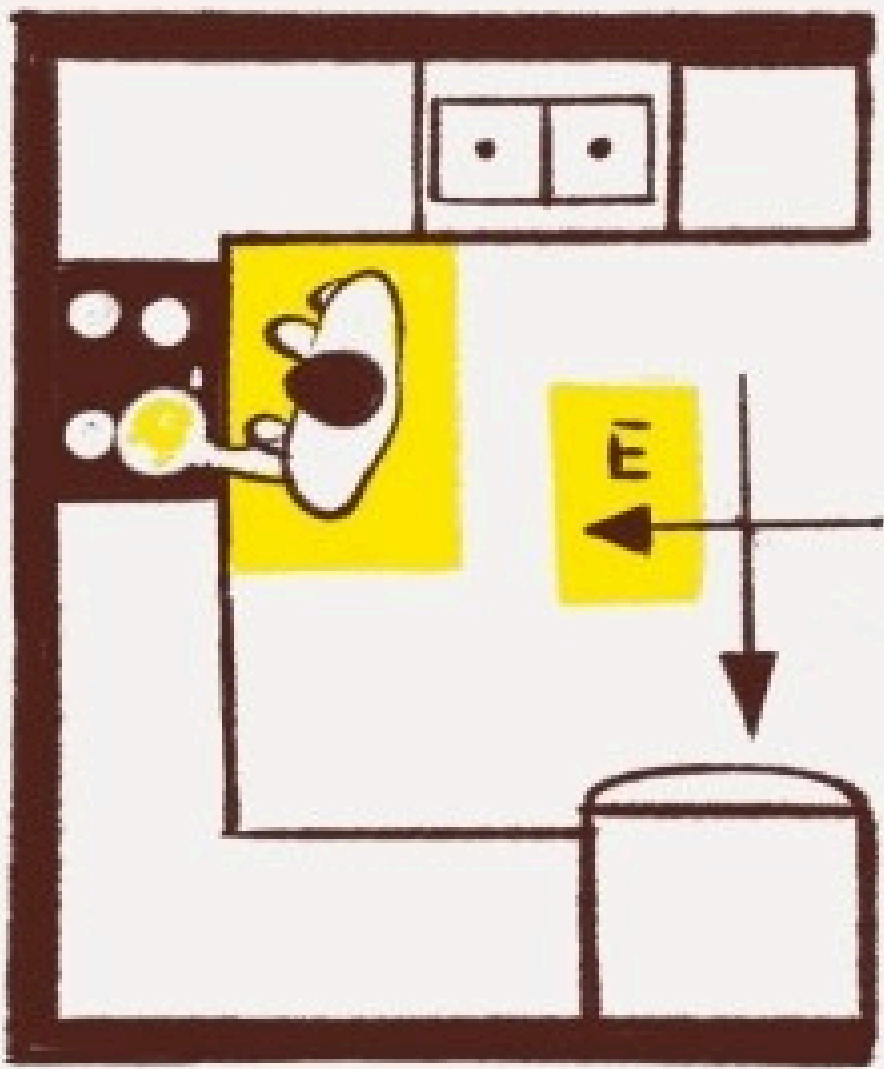

Place the stove or the hob in the southeast corner.

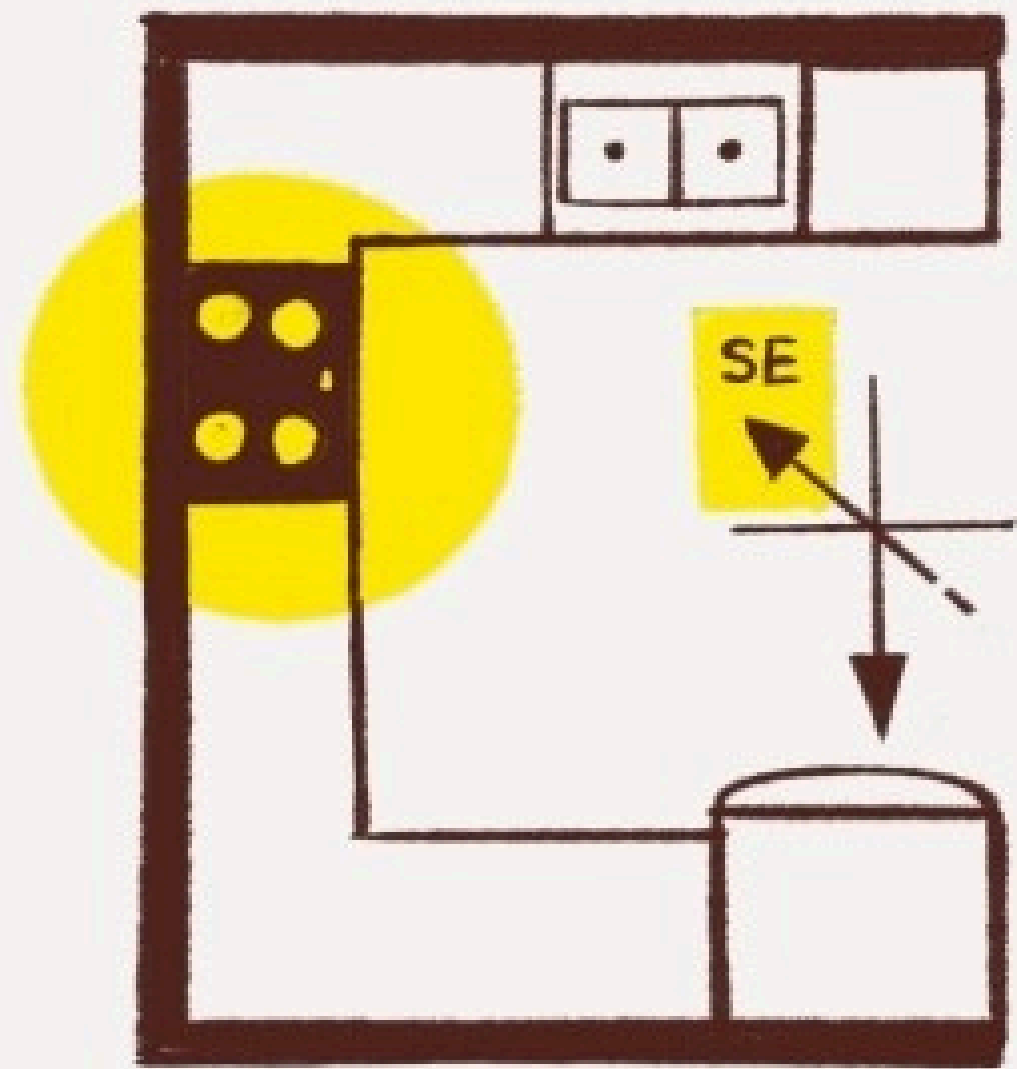

Southeast corner (Agneya) is the ideal direction for the kitchen to be. Northwest corner of the house can be the secondary option.

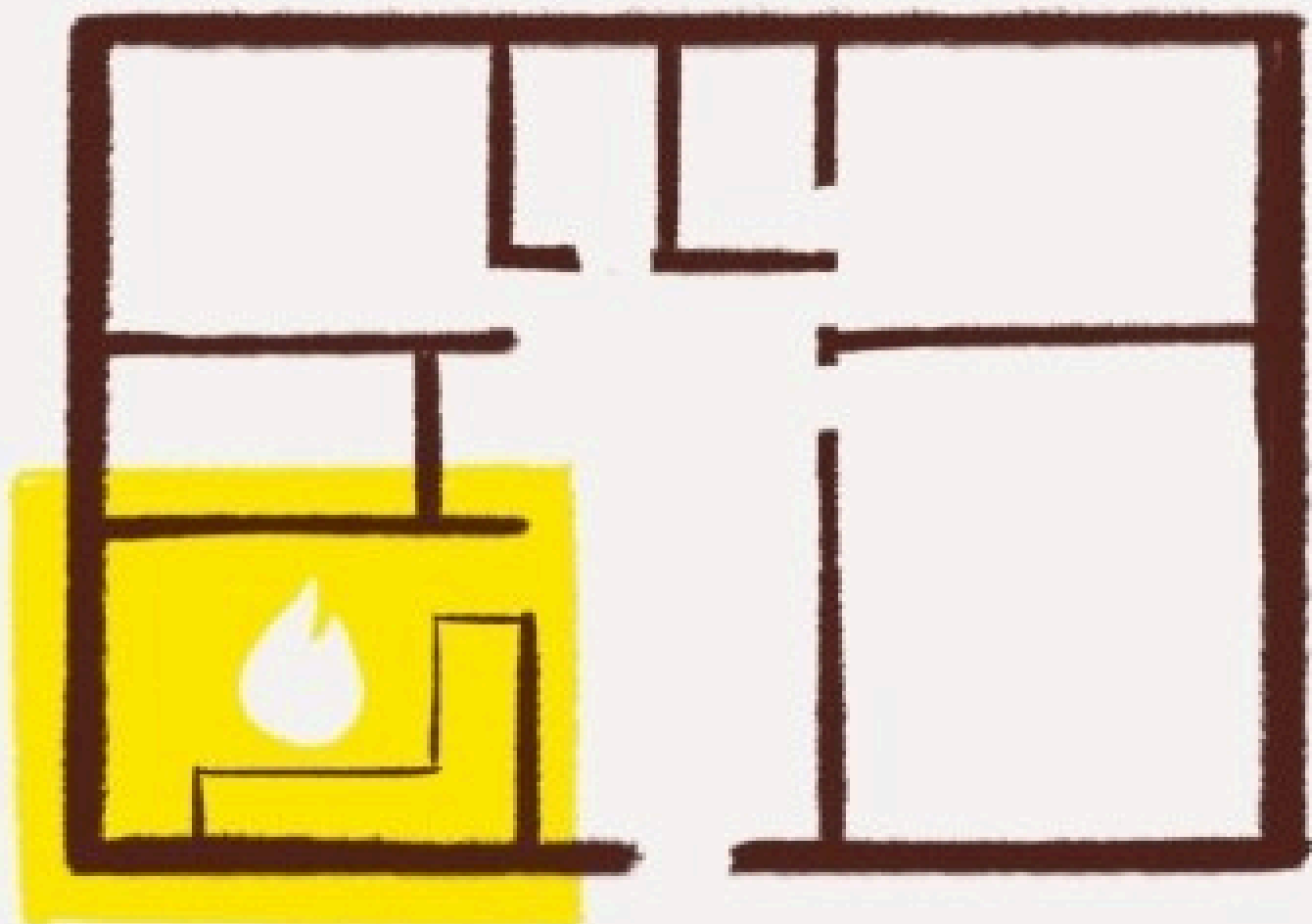

Form Composition:

Shapes like squares and rectangles are optimal for a positive energy flow.

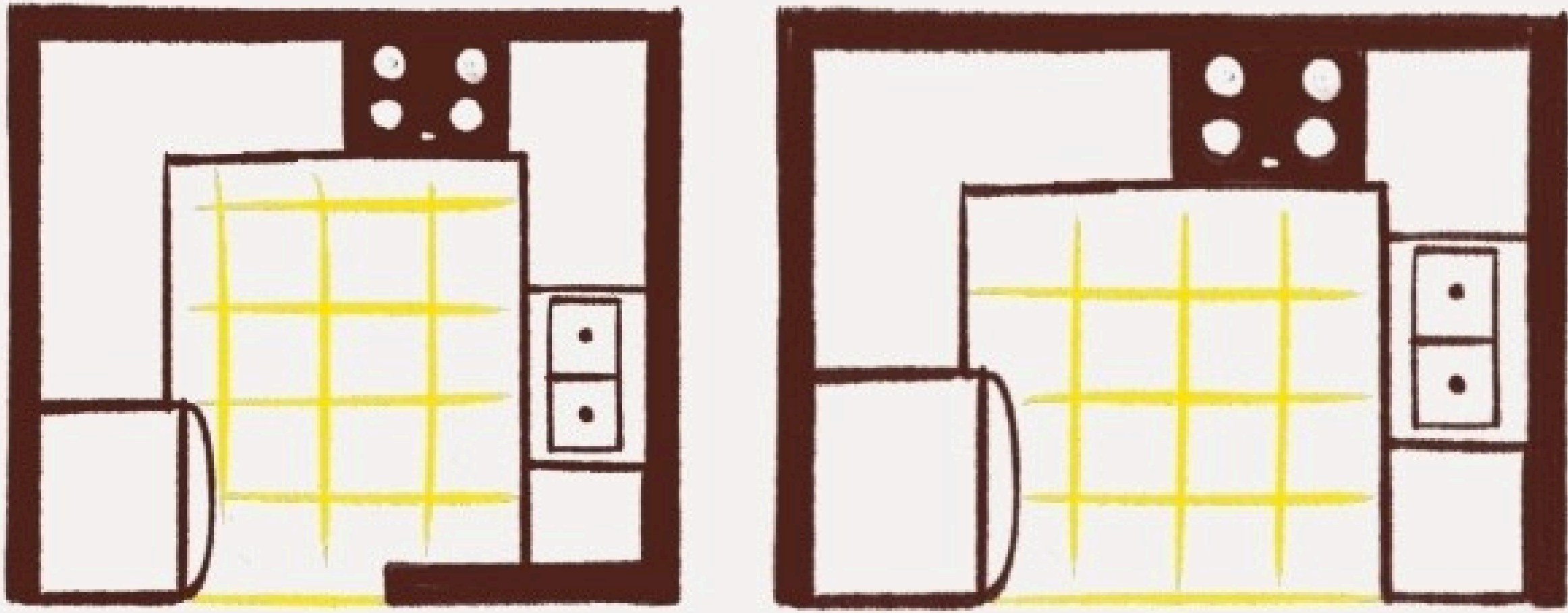

Avoid irregular shapes to ensure harmony and peace for the user.

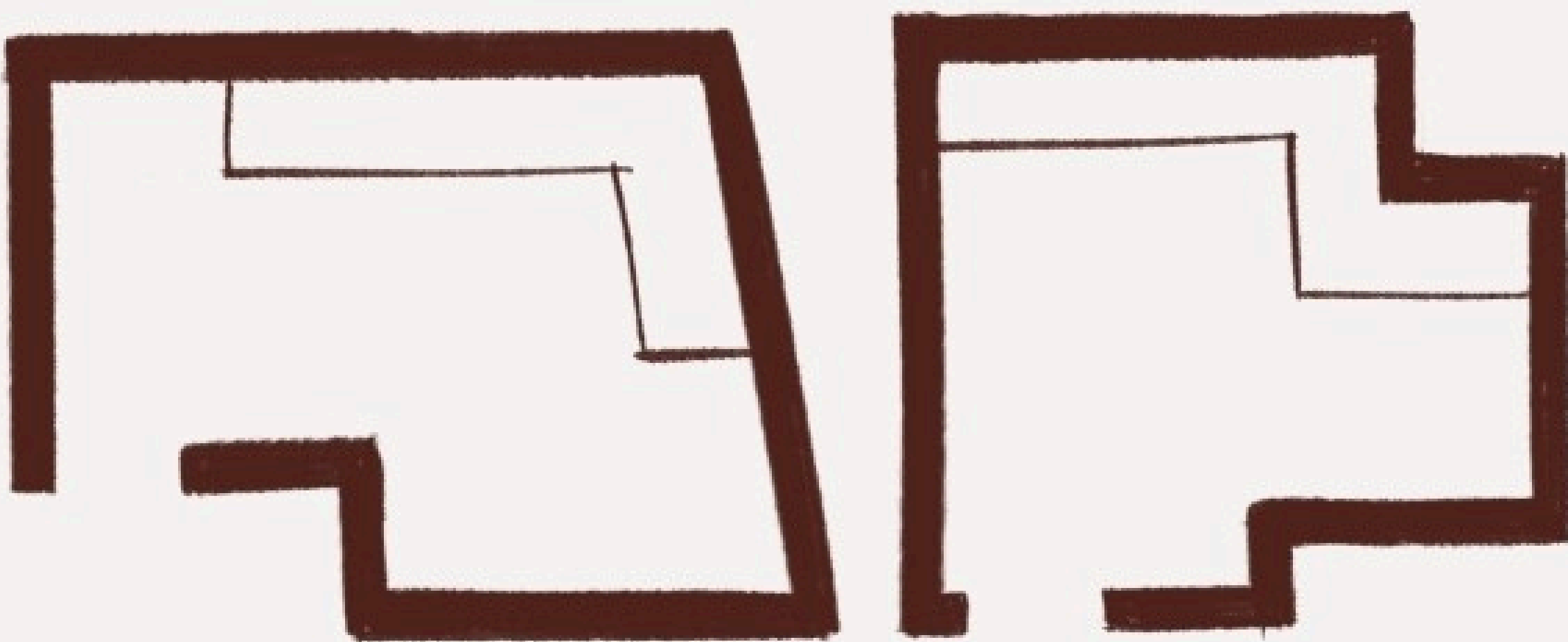



Commercial Spaces

Where careers are course-corrected...



Shagun:

Business ventures should start during auspicious months like Shravana or Phalgun, as these periods are believed to bring prosperity and align the business with favorable energies, enhancing the chances of success.

Significant Customs:

Office entrance should never be in the southwest direction, which could bring instability.

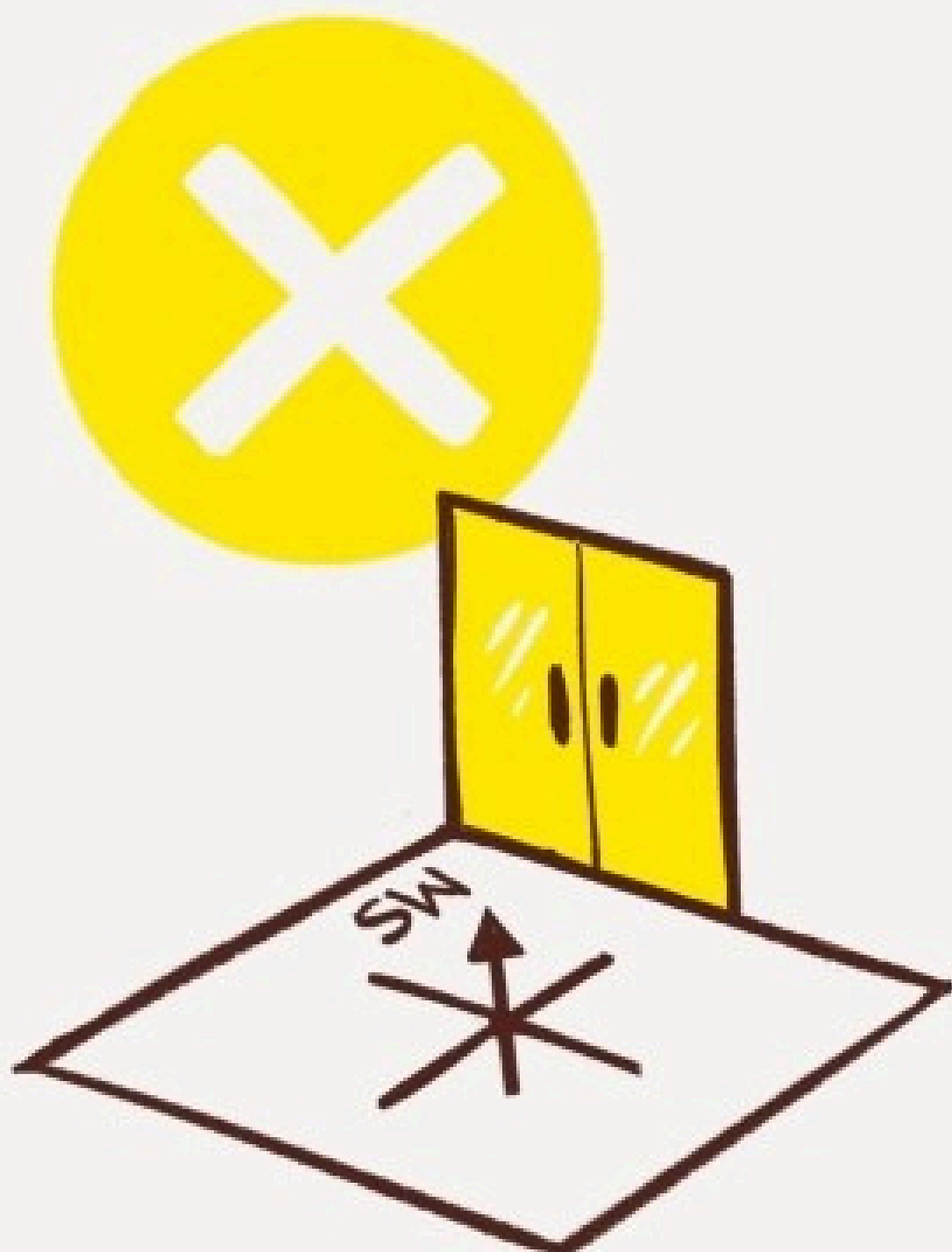

Use calming colors like blue or green for workspaces, avoiding sharp, dark tones.



Directional Considerations:

Reception areas should be in the northeast, inviting positive energy.

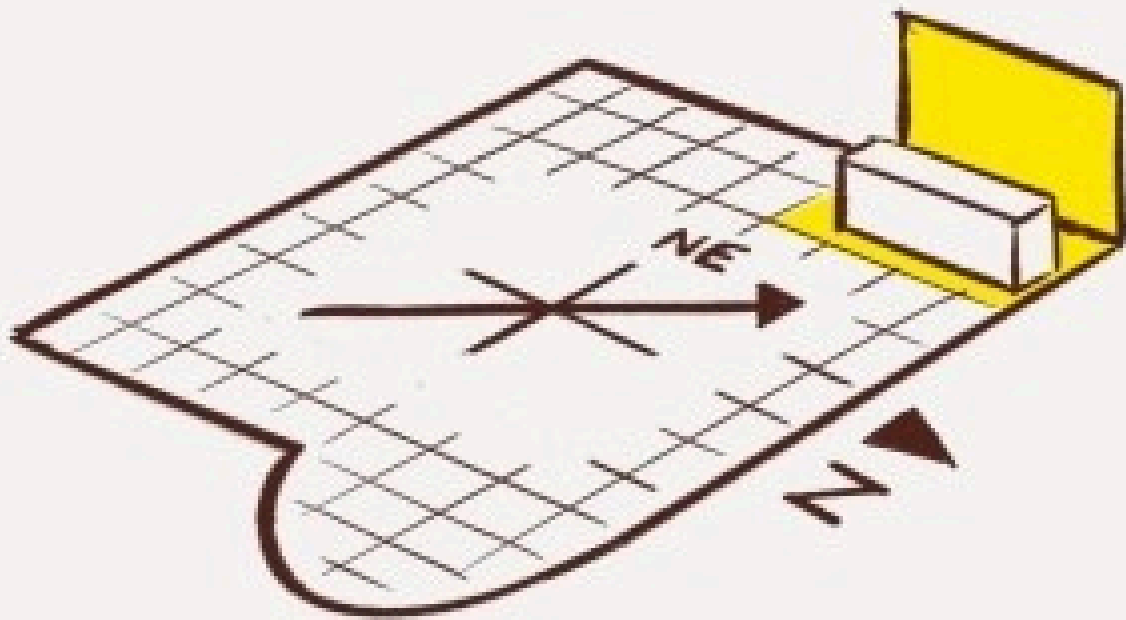

CEO or manager cabins should be in the southwest direction to empower them.

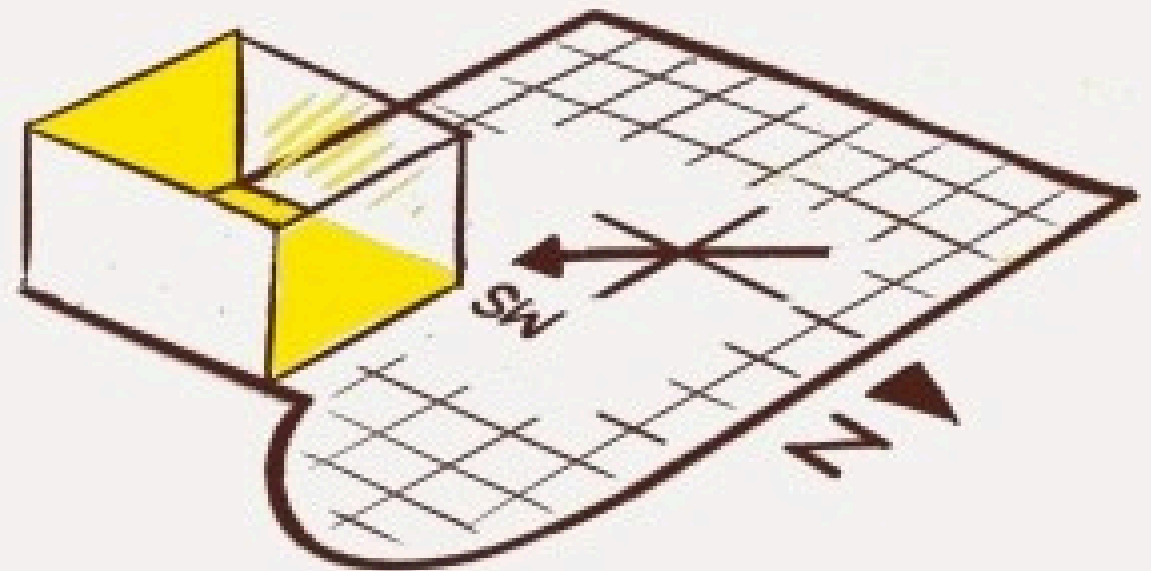

Cash registers or safes should be placed in the north, aligning with Kuber, the god of wealth.

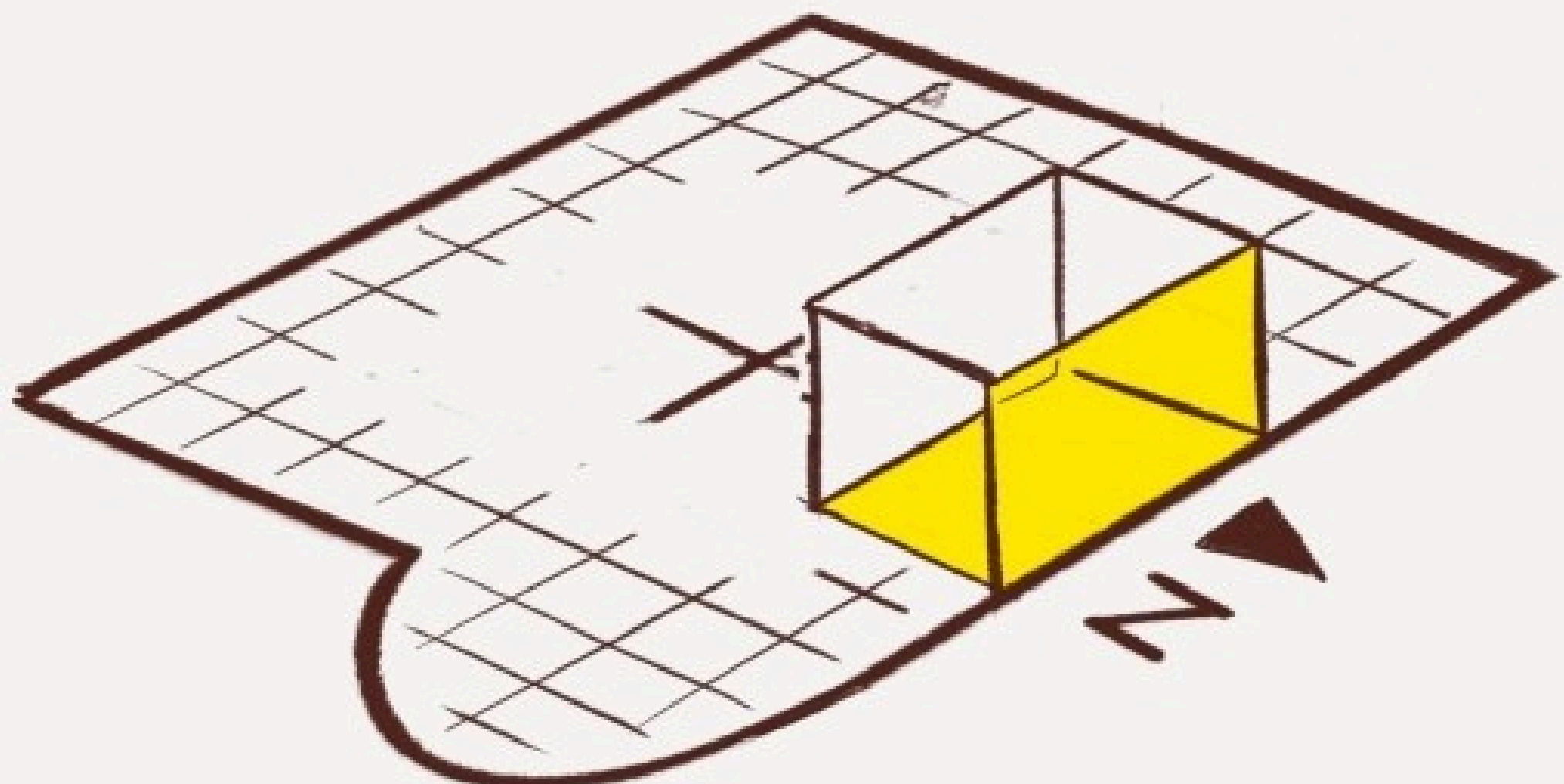

Form Composition:

Commercial spaces should be regular in shape, ideally rectangular.

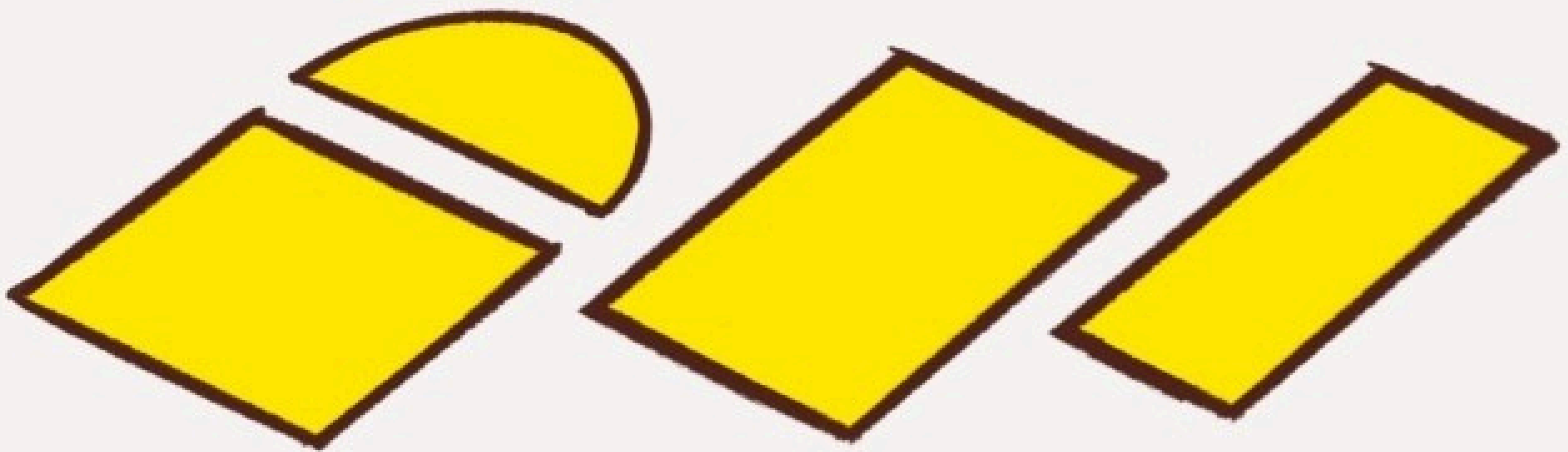

Irregularly shaped offices or shops could disturb the energy flow, leading to missed opportunities.

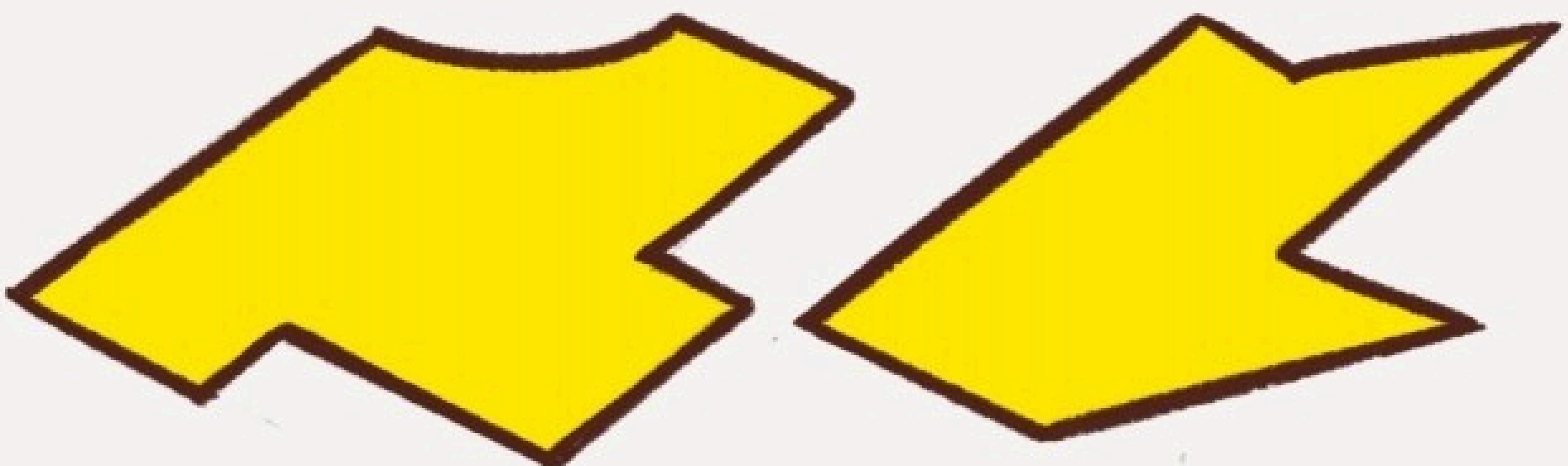

Directional Considerations:

North-east facing buildings reduce exposure to harsh sunlight, keeping interiors cooler.

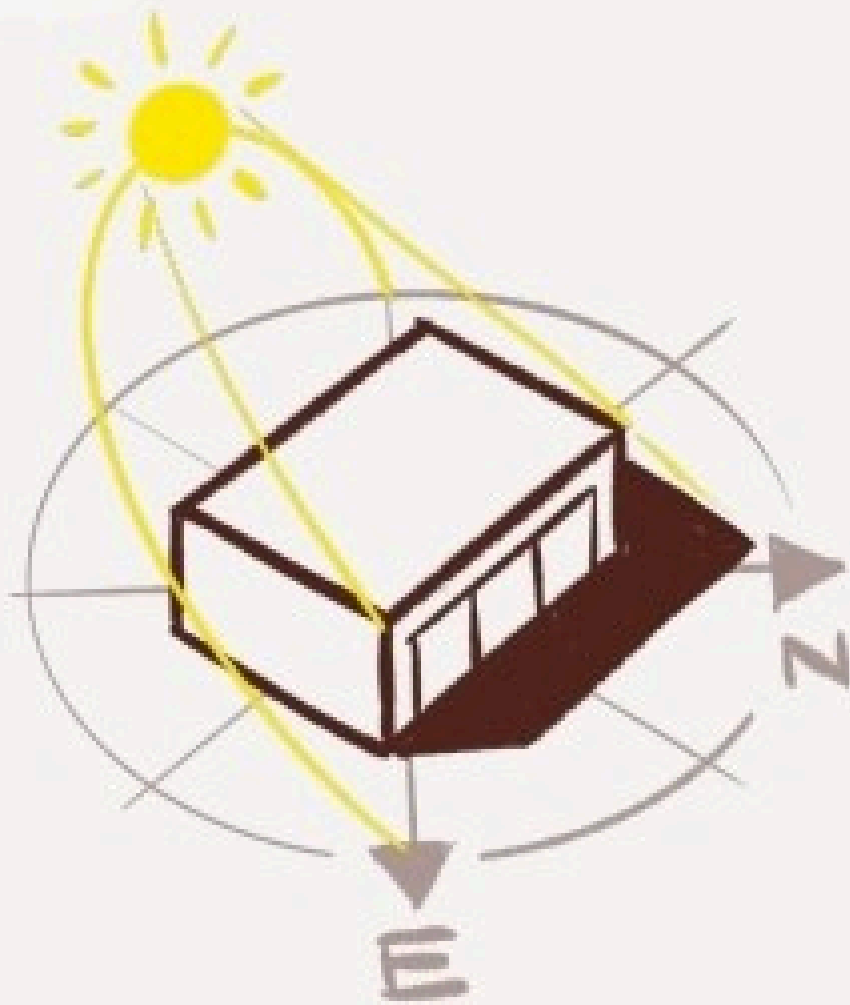

Avoid west or south-facing structures to minimize heat gain, especially in summer.

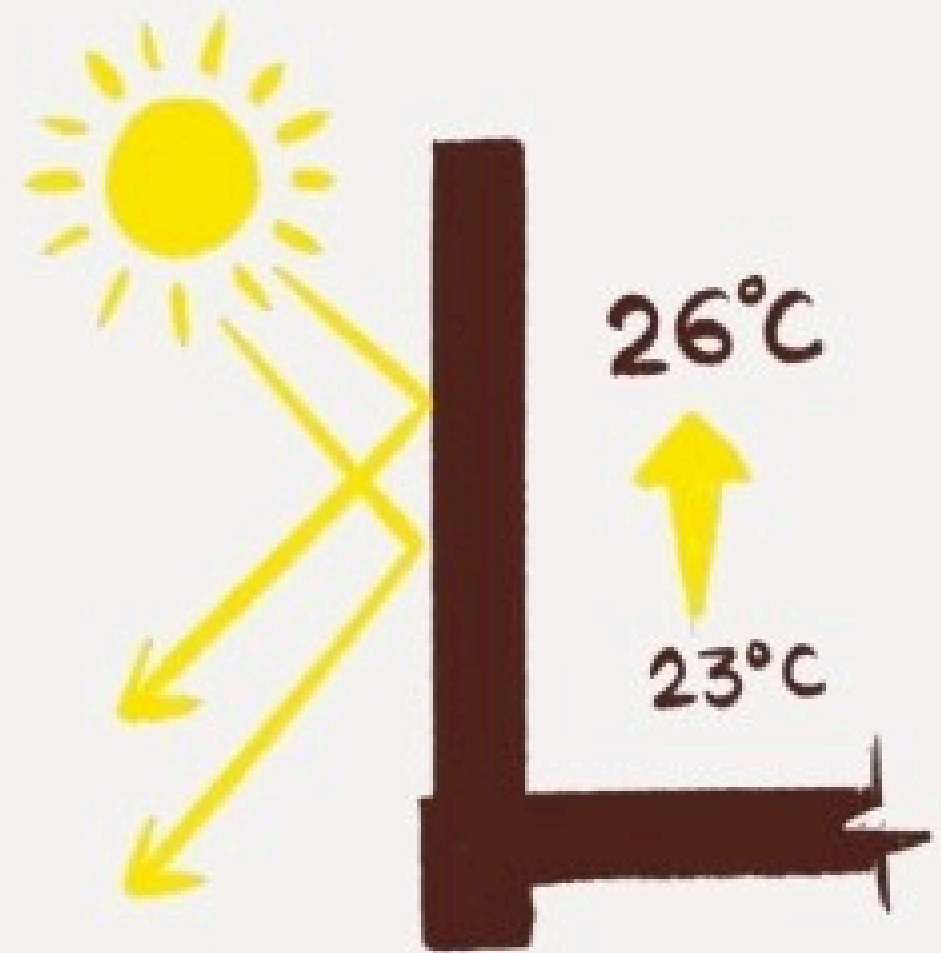

Use shading methods like verandas and trees in the south and west for heat control.



Ventilation and Windows:

Ensure cross-ventilation with large windows in the north and east for cooling breezes.

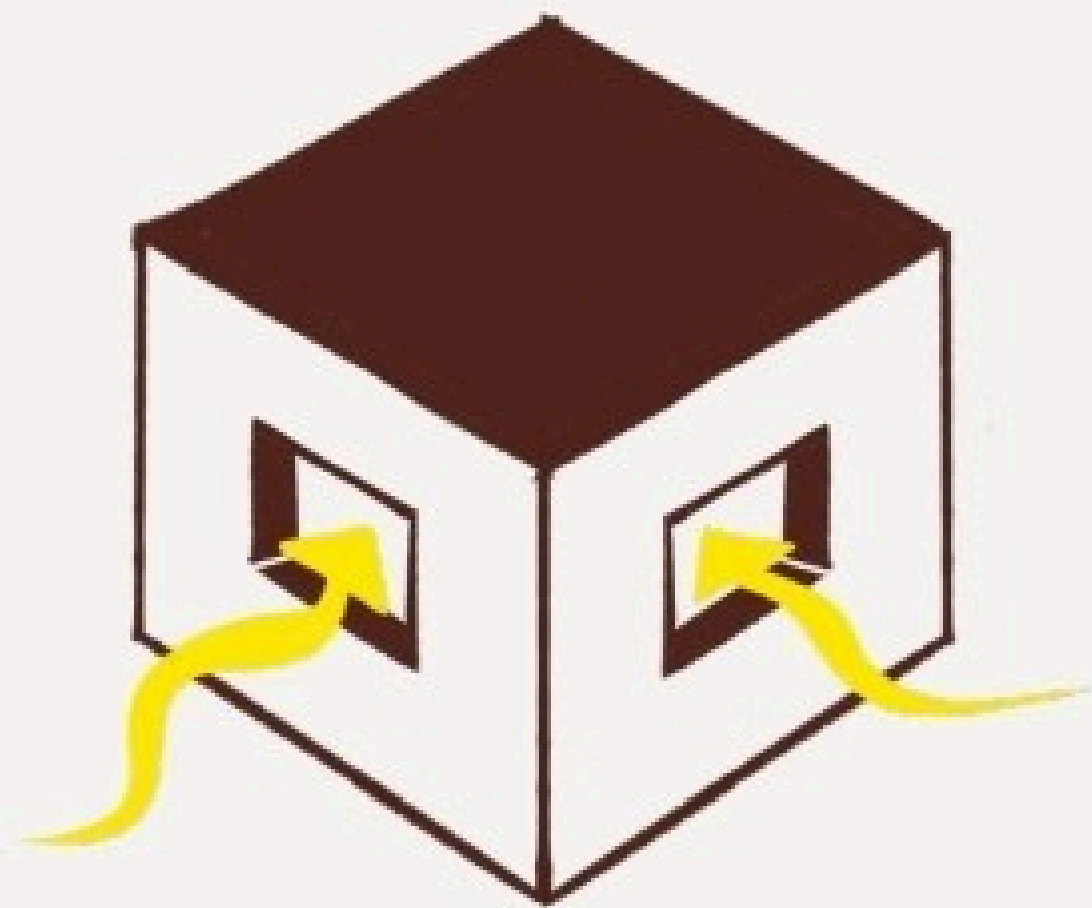

Limit large windows on the south side to avoid heat entry.

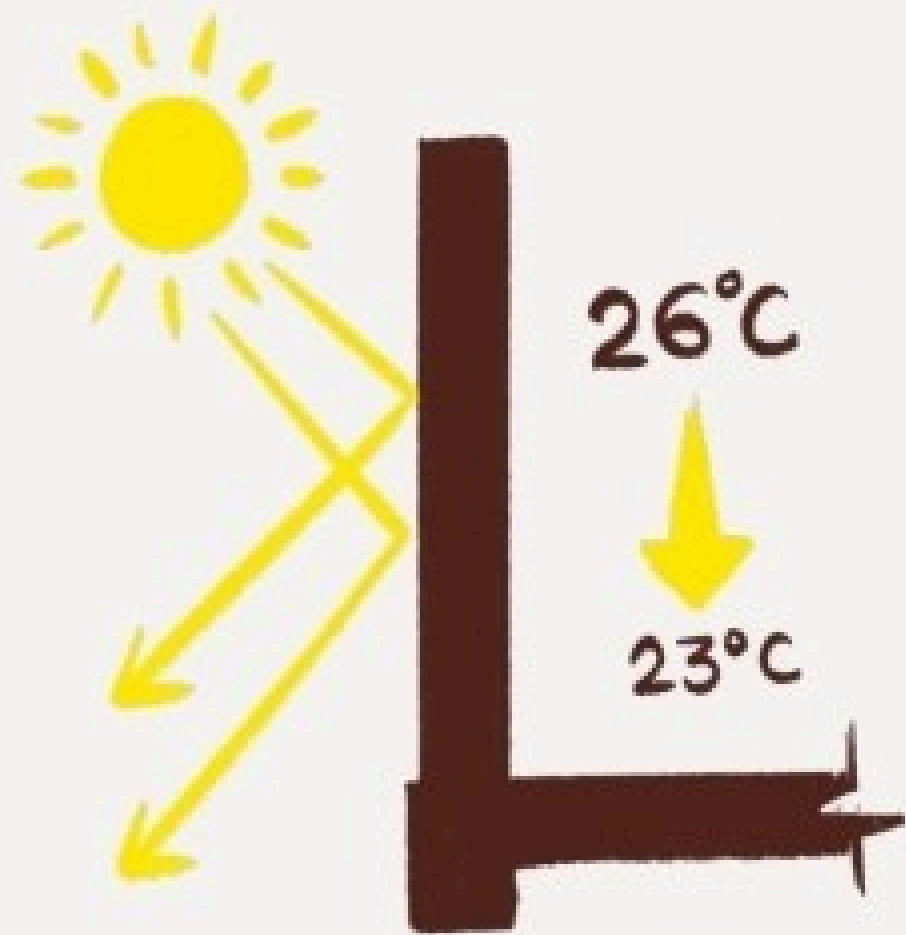

Incorporate courtyards for better air circulation and temperature control.



वक्रतुण्ड महाकाय सूर्यकोटि समप्रभः
निर्विघ्नं कुरु मे देव सर्वकार्येषु सर्वदा

We wish you a happy &
hassle-free constructions with Team
SHREE CONSTRUCTIONS & INTERIORS!

For enquiries

+91-9555-982-982

Info@shreeconstructions.homes

Address

**Shree Constructions & Interiors | Top Interior
Designer company In Rohini | Renovation | Architectural
241, pocket, 2, Block F, Sector 16,
Rohini, Delhi, 110089**